

BLOOMINGDALE PLACE DEVELOPMENT

SKETCH PLAN
PARCELS 342, 343 & 175, MAP 61, GRID 14
FEDERALSBURG CAROLINE COUNTY MARYLAND

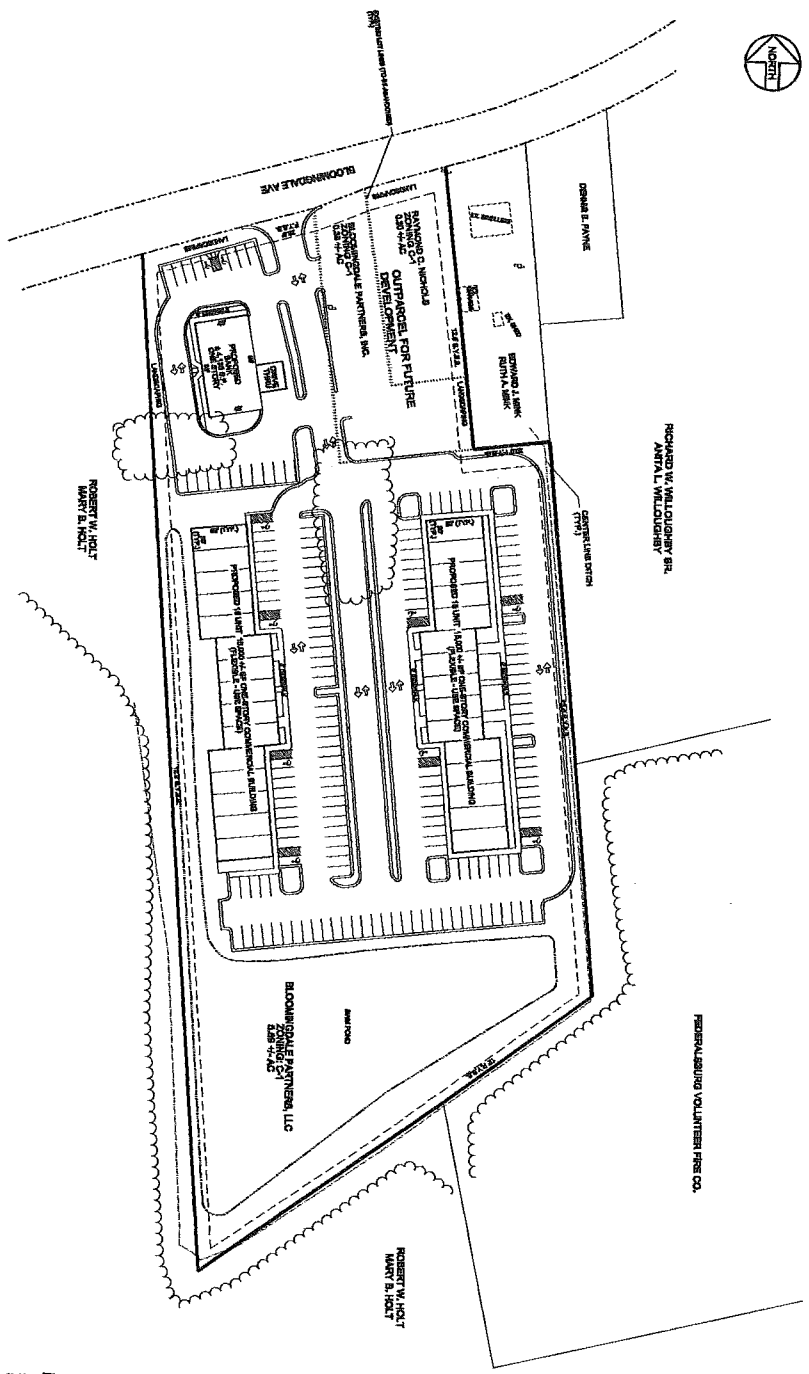

SITE DATA:

OWNER: BLOOMINGDALE PLACE DEVELOPMENT, INC.
DESIGNER: L. W. SALLIE ENGINEERING, INC.
DATE: JULY 2008

PROJECT: BLOOMINGDALE PLACE DEVELOPMENT, INC.
ADDRESS: PARCELS 342, 343 & 175, MAP 61, GRID 14
CITY: FEDERALSBURG, CAROLINE COUNTY, MARYLAND

PROJECT DESCRIPTION:
 DEVELOPMENT OF COMMERCIAL AND RESIDENTIAL USE PARCELS 342, 343 & 175, MAP 61, GRID 14, FEDERALSBURG, CAROLINE COUNTY, MARYLAND.

EXISTING CONDITIONS:
 PARCELS 342, 343 & 175, MAP 61, GRID 14, FEDERALSBURG, CAROLINE COUNTY, MARYLAND.

EXISTING UTILITIES:
 PARCELS 342, 343 & 175, MAP 61, GRID 14, FEDERALSBURG, CAROLINE COUNTY, MARYLAND.

EXISTING ZONING:
 PARCELS 342, 343 & 175, MAP 61, GRID 14, FEDERALSBURG, CAROLINE COUNTY, MARYLAND.

EXISTING SURVEY:
 PARCELS 342, 343 & 175, MAP 61, GRID 14, FEDERALSBURG, CAROLINE COUNTY, MARYLAND.

EXISTING RECORDS:
 PARCELS 342, 343 & 175, MAP 61, GRID 14, FEDERALSBURG, CAROLINE COUNTY, MARYLAND.

EXISTING ADJACENT PROPERTIES:
 PARCELS 342, 343 & 175, MAP 61, GRID 14, FEDERALSBURG, CAROLINE COUNTY, MARYLAND.

EXISTING ADJACENT OWNERS:
 PARCELS 342, 343 & 175, MAP 61, GRID 14, FEDERALSBURG, CAROLINE COUNTY, MARYLAND.

EXISTING ADJACENT STREETS:
 PARCELS 342, 343 & 175, MAP 61, GRID 14, FEDERALSBURG, CAROLINE COUNTY, MARYLAND.

EXISTING ADJACENT UTILITIES:
 PARCELS 342, 343 & 175, MAP 61, GRID 14, FEDERALSBURG, CAROLINE COUNTY, MARYLAND.

EXISTING ADJACENT RECORDS:
 PARCELS 342, 343 & 175, MAP 61, GRID 14, FEDERALSBURG, CAROLINE COUNTY, MARYLAND.

EXISTING ADJACENT ADJACENT PROPERTIES:
 PARCELS 342, 343 & 175, MAP 61, GRID 14, FEDERALSBURG, CAROLINE COUNTY, MARYLAND.

EXISTING ADJACENT ADJACENT OWNERS:
 PARCELS 342, 343 & 175, MAP 61, GRID 14, FEDERALSBURG, CAROLINE COUNTY, MARYLAND.

EXISTING ADJACENT ADJACENT STREETS:
 PARCELS 342, 343 & 175, MAP 61, GRID 14, FEDERALSBURG, CAROLINE COUNTY, MARYLAND.

EXISTING ADJACENT ADJACENT UTILITIES:
 PARCELS 342, 343 & 175, MAP 61, GRID 14, FEDERALSBURG, CAROLINE COUNTY, MARYLAND.

EXISTING ADJACENT ADJACENT RECORDS:
 PARCELS 342, 343 & 175, MAP 61, GRID 14, FEDERALSBURG, CAROLINE COUNTY, MARYLAND.

- NOTES:**
1. THIS SITE IS NOT LOCATED WITHIN THE CHESAPEAKE CRITICAL AREA.
 2. THIS SITE APPEARS TO BE LOCATED IN A PROPOSED PARKING AREA.
 3. THIS PROJECT IS SUBJECT TO ALL APPLICABLE REGULATIONS OF THE MARYLAND DEPARTMENT OF TRANSPORTATION.
 4. THIS PROJECT IS SUBJECT TO ALL APPLICABLE REGULATIONS OF THE MARYLAND DEPARTMENT OF TRANSPORTATION.

SKETCH PLAN

BLOOMINGDALE PLACE DEVELOPMENT
 PARCELS 342, 343 & 175, MAP 61, GRID 14
 FEDERALSBURG, CAROLINE COUNTY, MARYLAND

L. W. SALLIE ENGINEERING, INC.
 100 SOUTH MAIN STREET, SUITE 300
 FEDERALSBURG, MARYLAND 21732

DATE: JULY 2008 **PROJECT NO.:** 224-14-011 **SHEET NO.:** 1 of 1

BLOOMINGDALE PLACE DEVELOPMENT SKETCH PLAN

PARCELS 342, 343 & 175, MAP 61, GRID 14
FEDERALSBURG CAROLINE COUNTY MARYLAND

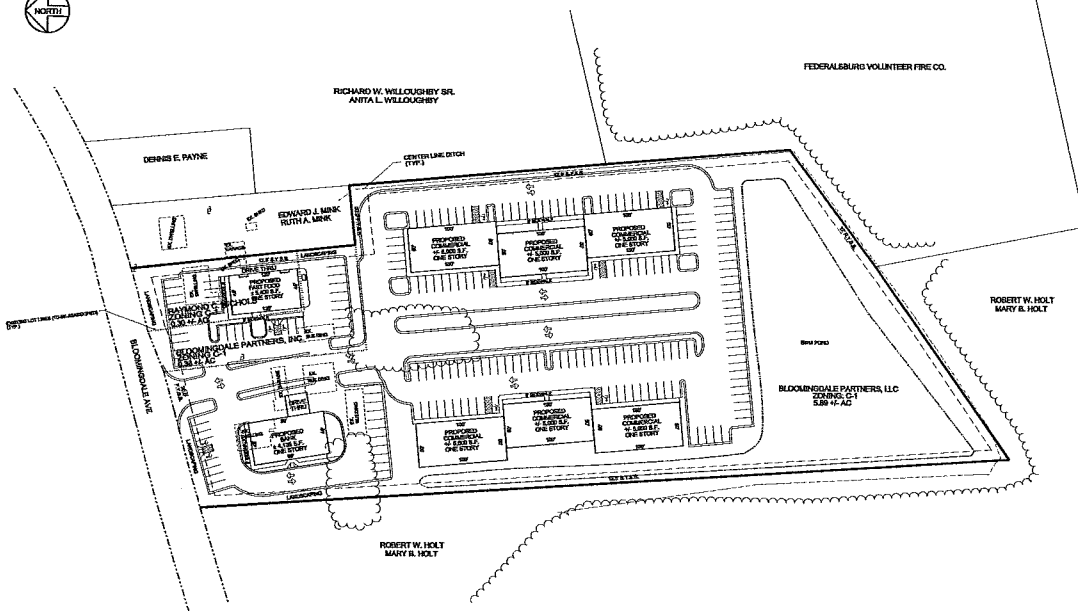

SITE DATA:

OWNER / APPLICANT / DEVELOPER:
BLOOMINGDALE PARTNERS, LLC

P.O. BOX 374
201 N. 4TH ROAD
FEDERALSBURG, MD 21731-0374
PHONE: 410-824-1123

SKETCH PLAN DESIGN:
J.W. SALAM ENGINEERING, INC.

1800 MAIN STREET, SUITE 8, P.O. BOX 807
FEDERALSBURG, MD 21731-0807
PHONE: 410-824-1123

PARCELS IDENTIFICATION:
PARCELS 342, 343 & 175, MAP 61, GRID 14
CAROLINE COUNTY, MARYLAND

PROJECT AREA: 4.97 AC.
TOTAL SITE: 10.41 AC.
SETBACKS FROM VARIOUS: 30 FEET
SETBACK: 15 FEET
REAR YARD: 10 FEET

EXISTING ZONING:

CU COMMERCIAL DISTRICT
PROPOSED USE:
BANK, FAST FOOD RESTAURANT, COMMERCIAL RETAIL,
SERVICE ESTABLISHMENTS AND OFFICES

BASE: FAST FOOD RESTAURANT 4,000 S.F.
COMMERCIAL RETAIL, SERVICE ESTABLISHMENTS AND OFFICES 1,000 S.F.

TOTAL: 5,000 S.F.
THERE ARE 200 PARKING SPACES PROVIDED.

NOTES:

1. THIS SITE IS NOT LOCATED WITHIN THE CHESAPEAKE CRITICAL AREA.
2. THIS SITE APPEARS TO BE LOCATED IN A PROHIBITED FLOODING AREA.
3. ALL EXISTING STRUCTURES TO BE REMOVED.
4. THIS PROJECT IS REQUIRED TO COMPLY WITH ALL APPLICABLE REQUIREMENTS OF THE SAVANNAH FOREST CONSERVATION ACT.



SKETCH PLAN			
BLOOMINGDALE PLACE DEVELOPMENT PARCELS 342, 343 & 175, MAP 61, GRID 14 BLOOMINGDALE PARTNERS, LLC			
J. W. SALAM ENGINEERING, INC. P.O. BOX 374, 201 N. 4TH STREET, SUITE 8 FEDERALSBURG, MD 21731			
SCALE:	DATE:	DRAWING NO.:	SHEET NO.:
1" = 50'	JULY 2008	226-01-001	1 of 1

"DRAFT"