

7/14/92 - Mansfield requests inspection 1:00

John M. Ryan, M.D.  
Health Officer

TALBOT COUNTY HEALTH DEPARTMENT  
P.O. BOX 480  
EASTON, MARYLAND 21601  
820-8213

Gary I. Rinehart  
Director of Environmental Health

Date 4/8/92

Permit No. 72508/70.00

*per GR*

APPLICATION FOR SANITARY CONSTRUCTION PERMIT

This permit is for an interim individual system. The property owners must discontinue use of this individual system & connect to the community system when the community system becomes available.

THIS APPLICATION MUST BE ACCOMPANIED BY A SITE PLAN OF THE PROPERTY.

1. OWNER BRENNAN George D <sup>Tamsey Farm</sup> 33376 Fox Rd. Easton, Md. 21601 822-7432  
Last Name First Name P.O. Address Phone No.

2. APPLICANT S/A GENERAL CONTRACTOR MANSFIELD & SONS

3. Give directions to property including subdivision name and lot number.  
Route 328 toward Denton - Turn Right on Fox Road. go all the way back - to main house

4. Size of Lot 103.924 acres 5. Type of Construction:  New Building  Repair  Conn. to sewer  
 Remodeling  Mobile Home

6. Planned use of building:  Residence  Commercial # of persons using 24 hr. 3  
Sq. Ft. of Living area 3472 # of Bedrooms 5 Type 2 Story BRICK

Garbage Disposal  Yes  No Ground Water Heat Pump  Yes  No Jacuzzi tub # of gals. 200 gal  
*\* Used only 6 times anyone uses outside one most of the time*

7. Type of sewage disposal system:  
 Septic Tank System  Connection to Public Sewer  Other

8. Type of water supply:  Deep  Shallow Distance of water supply to disposal system over 50 ft.

IMPORTANT: NO BUILDING CONSTRUCTION OR SANITARY CONSTRUCTION SHALL BE STARTED BEFORE RECEIVING APPROPRIATE PERMITS. ANY CHANGES IN SANITARY CONSTRUCTION MUST HAVE THE APPROVAL OF THE SECTION OF ENVIRONMENTAL HEALTH OF TALBOT COUNTY HEALTH DEPARTMENT.

9. Soil test results: Percolation Rate \_\_\_\_\_ minutes. Infiltration rate \_\_\_\_\_ ft. Soil Type DAB?  
Soil test made by See profiles by Mansfield

10. Septic Tank Specifications: Number of tanks \_\_\_\_\_  
 800 gallon  1,000 gallon  1,000 gallon two compartment  1,500 gallon

11. Tile field (if used): Total length of tile \_\_\_\_\_ ft. Number of trenches \_\_\_\_\_  
Length of each trench \_\_\_\_\_ ft. Width of each trench 2 ft. Depth of trench 4 1/2

12. Seepage pits (if used): Total depth \_\_\_\_\_ ft. Size \_\_\_\_\_ ft. Eff. depth \_\_\_\_\_ Number \_\_\_\_\_

13. Additional system specifications: Sand lined trench ✓; 6" stone below & 2" above \_\_\_\_\_; 8" tubing \_\_\_\_\_; 10" tubing \_\_\_\_\_; Invert of drainfield \_\_\_\_\_; Pump needed \_\_\_\_\_;

Install when ground water table is absent \_\_\_\_\_; Mound over trench \_\_\_\_\_;  
See proposal by Mansfield for additional specifications and site plan.

14. Recommendations: \_\_\_\_\_

15. I, George D Brennan (Signature of Owner) hereby agree to have the sewage disposal facilities installed in accordance with regulations COMAR 26.04.02 of the Dept. of Health & Mental Hygiene under the supervision of the Talbot County Health Department. I also agree to notify the Talbot County Health Department before actual construction is begun. Should this system fail, I agree to make any changes deemed necessary.

THIS APPLICATION SHALL EXPIRE ONE YEAR FROM DATE OF ISSUE PROVIDED CONSTRUCTION HAS NOT BEGUN, OTHERWISE, IT IS VALID FOR TWO YEARS.

16. Application approved 4/17/92 Date [Signature] Sanitarian

Subdivision \_\_\_\_\_  
Map 20 Block 20 Parcel 11 Lot # \_\_\_\_\_

Each Square Equals 5 Feet

steep

H<sub>2</sub>O

200

175

150

125

100

75

50

25

25

50

75

100

125

150

175

System Installed by Mansfield & Sons

Note: Notify the County Health Department between the hours of 8-9 a.m. on the day of installation, so inspection can be made while work is in progress.

Representatives of the County Health Department may make inspections during construction to determine compliance with the Regulations of the State Board of Health and the Local Board of Health. No part of any installation shall be covered until inspected and given final written approval by the County Health Department. Any part of an installation which has been covered prior to final approval shall be uncovered on order of the County Health Department.

**THERE WILL BE NO FINAL INSPECTIONS MADE ON WEEKENDS OR HOLIDAYS**

Final Inspection: Plan "B" - Trench Bottom 54" - observed bottom of trench (A)  
trenches backfilled w/ sand & stone. (sand beginning 31") FMV. at D. Box - 30"

Date 7/14/92 Time 12:30-1:00 Sanitarian Ann D. Morse, R.S

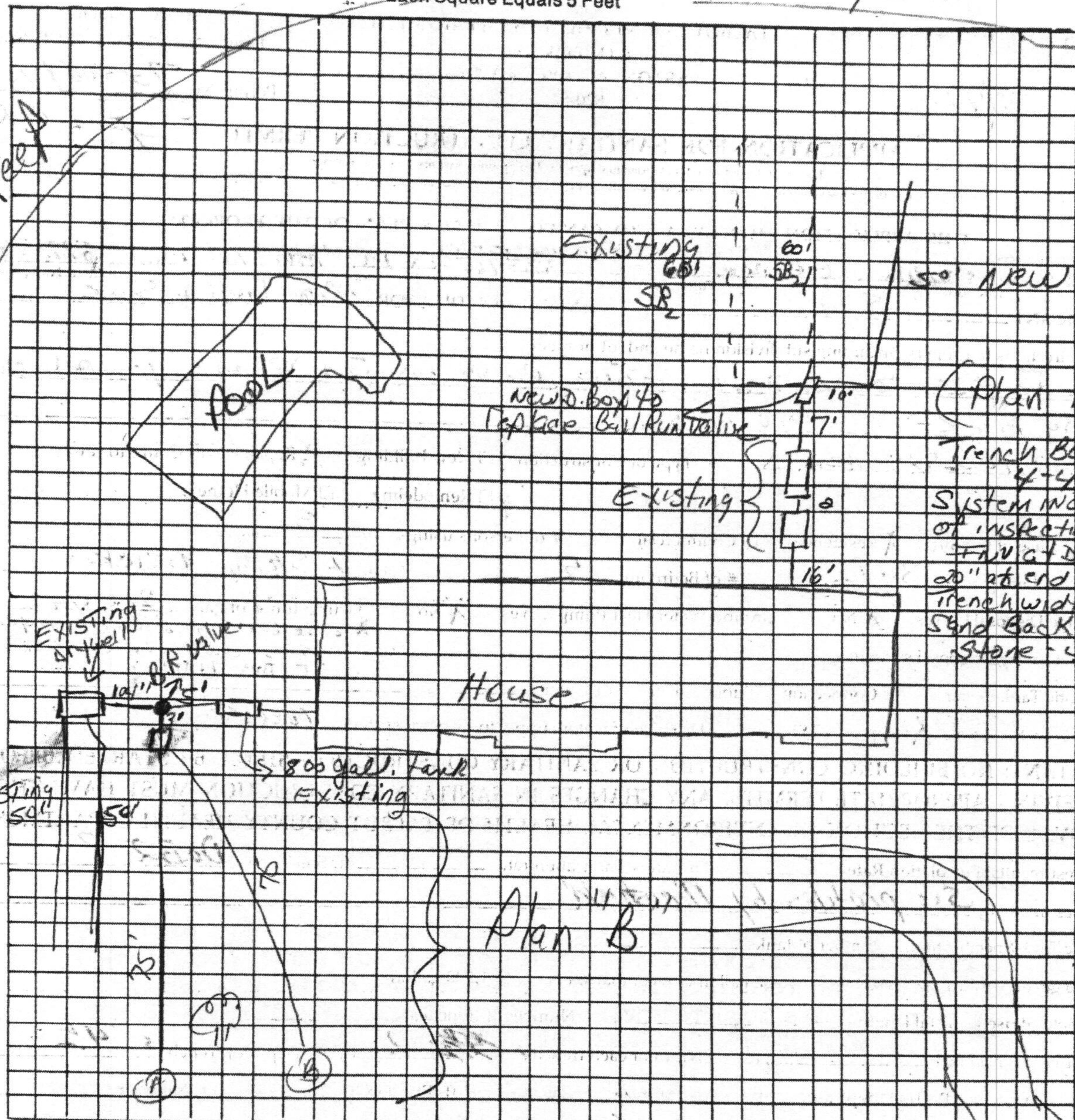

(Plan A)  
 Trench Bottom - 4'-4 1/2' Deep.  
 System not time of inspection.  
 FMV at D. Box - 24" x 20" at end of tile.  
 Trench width 4'-5"  
 Sand Backfill x Stone - 4" per.

HOUSE

POOL

Plan "B"

800 gall. Tank  
EXISTING

EXISTING D. Box

EXISTING SR2

NEW D. Box to replace Bell Run Valve

EXISTING

EXISTING 50"

EXISTING D. Box

(A)

(B)

Trench Bottom - 4'-4 1/2' Deep.  
 System not time of inspection.  
 FMV at D. Box - 24" x 20" at end of tile.  
 Trench width 4'-5"  
 Sand Backfill x Stone - 4" per.

MANS Field & Sons Inc  
 31035 Asches Acres Rd  
 Cordova, Md. 21625.

Pg I

George D. BRENNAN  
 TAMSEY FARM  
 33376 Fox Rd  
 EASTON, Md 21601  
 MAP 20 - BL-20 - Parcel 11

Note: \*  
 \* Scale is intended for orientation of House & Septic Area for Health Dept. Use only - MANS Field & Sons Inc.

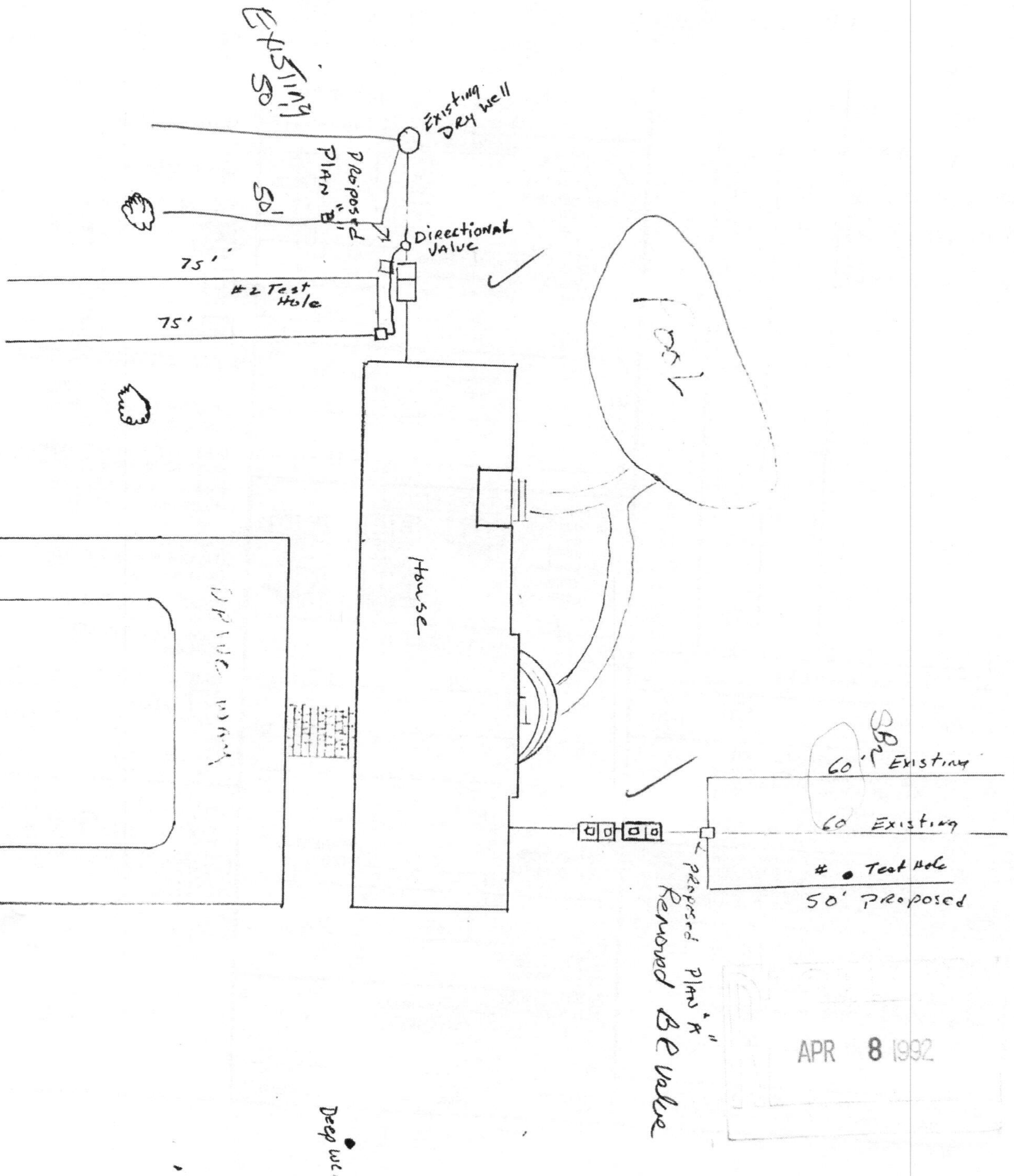

SCALE 1" = 30'