





Mailed 10/31/13  
FILE COPY

**DORCHESTER COUNTY HEALTH DEPARTMENT  
ENVIRONMENTAL HEALTH DIVISION**

3 Cedar Street  
Cambridge, MD 21613

Roger L. Harrell, MHA  
Health Officer

410-228-1167  
FAX: 410-901-8192

October 2, 2013

Brainard H. Warner, IV  
3585 Hamlet Place  
Chevy Chase, MD 20815

Re: Report of Site Evaluations for Individual On-site Waste Disposal, SE#2301  
5608 Daniel's Choice Road, Cambridge  
Tax Map 29, Parcel 66, Lots 1 & 2, Radcliffe Acres

Dear Mr. Warner,

Additional site evaluations for on-site sewage disposal on the referenced lots were completed by this office on 3/20/2013. The results of all the site evaluations indicate that both lots do not meet the criteria for onsite sewage disposal as required in:

1. COMAR 26.04.02
2. Dorchester County Groundwater Protection Report
3. Design and Construction Manual for Sand Lined Trench Systems
4. Design and Construction Manual for Bermed Infiltration Pond (BIP) Systems

These evaluations were done to determine if a prior evaluation and permit denial in April 1979 could be overturned. All of the observations in 2012 and 2013 were consistent with the 1979 evaluation. A total of 12 backhoe holes to depths of 13 to 14 feet were observed. The only sandy layers found were in the northeast corner of lot 2. In addition, the BIP serving the existing house on lot 2 was observed cresting on 3/13/2013 and 3/20/2013 even though the house had not been occupied for some time. The BIP does not infiltrate the precipitation input, and would fail more frequently with any wastewater input.

The site characteristics observed were:

Lot	Depth to High Water	Soil Permeability				
			Test Type	Depth	Result	
1	0-6" est.	PZ1	Slug Test	4-7'	1.4 in/hr	Unsuitable for SLT and BIP due to high water table and lack of a sufficiently permeable extensive receiving stratum
		PZ2	Slug Test	11.5-15.5'	<<1.0 in/hr	
2	3-9" Pz 3&4	BH5	Visual	6-7'	ls/s	Unsuitable for SLT due to high water table

At your request, we met to review this case on 5/20/2013. Lot 1 remains unapprovable for onsite sewage disposal. As there is an existing house on lot 2, this office will allow the construction of an Elevated Sand Lined Trench to replace the failing BIP. The trenches must be constructed in the northeast corner of the lot next to the driveway. The system will require a Best Available Technology (BAT) pretreatment unit. This site is eligible for a grant to cover up to 100% of the cost of installation of that unit. Drainfield costs are not eligible. You were provided application forms for a Sanitary Construction Permit and the BRF Grant Program. If you have any questions concerning this matter, please call me at 410-228-1167 or email at [william.forlifer@maryland.gov](mailto:william.forlifer@maryland.gov) .

Sincerely,

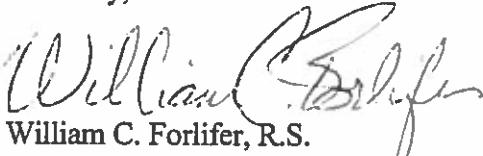
  
William C. Forlifer, R.S.  
Director of Environmental Health

cc: Naomi Howell, R.S., MDE Regional Sanitarian  
Roger Harrell, MHA, Health Officer



# SITE SKETCH

WARNER, 5608 DANIELS CHOICE RD

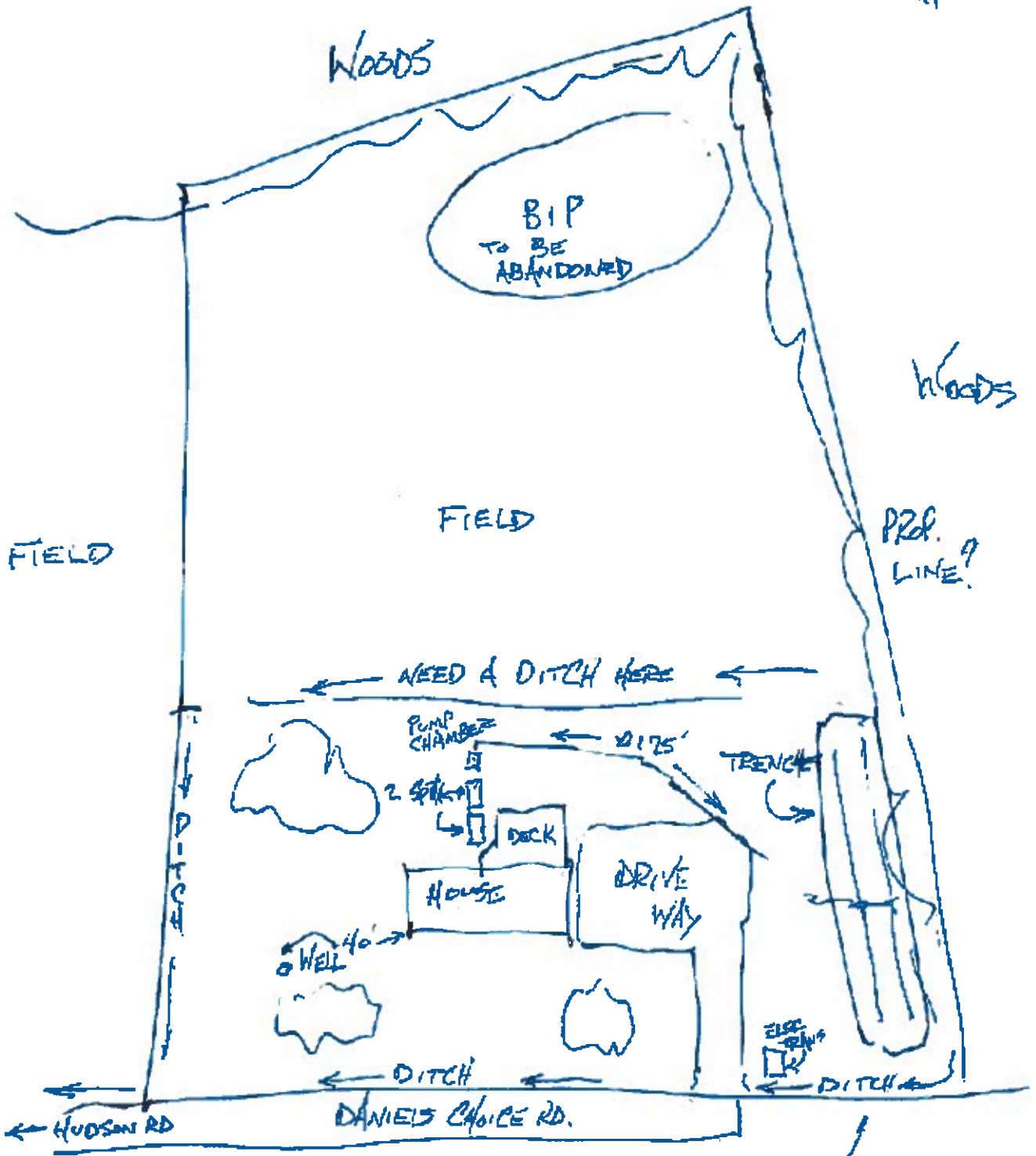

Well is 150' FROM DRINKING FIELD



011 0014 (MDE USE ONLY)

# STATE OF MASSACHUSETTS WELL COMPLETION REPORT

FILL IN THIS FORM COMPLETELY  
PLEASE TYPE

45 DAYS AFTER WELL IS COMPLETED.  
COUNTY NUMBER **D**  
PERMIT NO. FROM "PERMIT TO DRILL WELL"  
**00-94-0198**

ST/CO USE ONLY  
DATE Received  
**09-24-01**

DATE WELL COMPLETED  
MM **5** DD **01** YY **01**  
Depth of Well  
**22** **380** **26**  
(TO NEAREST FOOT)

OWNER  
last name **Jones** first name **William Dale**  
STREET OR RFD **5608 Daniels Chase Rd** TOWN **Cambridge MA 01613**  
SUBDIVISION \_\_\_\_\_ SECTION \_\_\_\_\_ LOT \_\_\_\_\_

### WELL LOG

Not required for driven wells

STATE THE KIND OF FORMATIONS PENETRATED, THEIR COLOR, DEPTH, THICKNESS AND IF WATER BEARING

DESCRIPTION (Use additional sheets if needed)	FEET		check if water bearing
	FROM	TO	
Clay	0	11	
Tan Sand	11	13	
Grey Clay	13	50	
Shall Sand & Clay	50	110	
Grey Clay	110	308	
Crusty Sand	308	340	
Grey + Brown Sand	340	380	

### GROUTING RECORD

WELL HAS BEEN GROUTED (Circle Appropriate Box)  
 Y  N  
TYPE OF GROUTING MATERIAL (Circle one)  
CEMENT  CM BENTONITE CLAY  BC  
NO. OF BAGS <sup>45 46</sup> **7** NO. OF POUNDS <sup>45 46</sup> **350**  
GALLONS OF WATER **175**  
DEPTH OF GROUT SEAL (to nearest foot)  
from **3** ft. to **150** ft.  
48 TOP 52 54 BOTTOM 58  
(enter 0 if from surface)

CASING RECORD  
casing types insert appropriate code below  
 ST STEEL  CO CONCRETE  
 PL PLASTIC  OT OTHER

MAIN CASING TYPE  
Nominal diameter top (main) casing (nearest inch) **4** Total depth of main casing (nearest foot) **196**  
 PL **60 61** **63 64** **66 70**

OTHER CASING (if used)  
EACH CASING diameter inch depth (feet) from to  
**PL 2 196 360**

SCREEN RECORD  
screen type or open hole insert appropriate code below  
 ST STEEL  BR BRASS  HO OPEN HOLE  
 PL PLASTIC  OT OTHER

DEPTH (nearest ft.)  
**C 2**  
**PL 360 380**

SLOT SIZE 1 **20** 2 \_\_\_\_\_ 3 \_\_\_\_\_  
DIAMETER OF SCREEN **2** (NEAREST INCH)  
58 \_\_\_\_\_ 60 \_\_\_\_\_  
from \_\_\_\_\_ to \_\_\_\_\_

GRAVEL PACK IF WELL DRILLED WAS FLOWING WELL INSERT F IN BOX 68  
**350 380**  
\_\_\_\_\_ 68 \_\_\_\_\_

MDE USE ONLY (NOT TO BE FILLED IN BY DRILLER)  
T \_\_\_\_\_ (E.R.O.S.) W Q \_\_\_\_\_

TELESCOPE CASING LOG INDICATOR OTHER DATA  
70 \_\_\_\_\_ 72 \_\_\_\_\_ 74 75 76 \_\_\_\_\_

### PUMPING TEST

HOURS PUMPED (nearest hour) **6**  
8 9  
PUMPING RATE (gal. per min.) **40**  
11 15  
METHOD USED TO MEASURE PUMPING RATE **Direct**  
WATER LEVEL (distance from land surface)  
BEFORE PUMPING **65** ft.  
17 20  
WHEN PUMPING **100** ft.  
22 25  
TYPE OF PUMP USED (for test)  
 A air  P piston  T turbine  
 C centrifugal  R rotary  O other (describe below)  
 J jet  S submersible

PUMP INSTALLED  
DRILLER INSTALLED PUMP (CIRCLE) (YES OR NO)  YES NO

IF DRILLER INSTALLS PUMP, THIS SECTION MUST BE COMPLETED FOR ALL WELLS.  
TYPE OF PUMP INSTALLED PLACE (A,C,J,P,R,S,T,O) IN BOX 29. **5**  
**29**

CAPACITY: GALLONS PER MINUTE (to nearest gallon) **10**  
31 35  
PUMP HORSE POWER **.5**  
37 41  
PUMP COLUMN LENGTH (nearest ft.) **100**  
43 47

CASING HEIGHT (circle appropriate box and enter casing height)  
 + above } LAND SURFACE  
 - below } (nearest foot)  
**49** **2**  
49 50 51

LOCATION OF WELL ON LOT  
SHOW PERMANENT STRUCTURE SUCH AS BUILDING, SEPTIC TANKS, AND /OR LANDMARKS AND INDICATE NOT LESS THAN TWO DISTANCES (MEASUREMENTS TO WELL)



NUMBER OF UNSUCCESSFUL WELLS: \_\_\_\_\_

WELL HYDROFRACTURED  Y  N

CIRCLE APPROPRIATE LETTER  
 A WELL WAS ABANDONED AND SEALED WHEN THIS WELL WAS COMPLETED  
 E ELECTRIC LOG OBTAINED  
 P TEST WELL CONVERTED TO PRODUCTION WELL

I HEREBY CERTIFY THAT THIS WELL HAS BEEN CONSTRUCTED IN ACCORDANCE WITH COMAR 26.04.04 "WELL CONSTRUCTION" AND IN CONFORMANCE WITH ALL CONDITIONS STATED IN THE ABOVE CAPTIONED PERMIT, AND THAT THE INFORMATION PRESENTED HEREIN IS ACCURATE AND COMPLETE TO THE BEST OF MY KNOWLEDGE

DRILLERS LIC. NO. **M 5 D 0 2 2 1**

DRILLERS SIGNATURE \_\_\_\_\_  
(MUST MATCH SIGNATURE ON APPLICATION)

LIC. NO. **M D**

SITE SUPERVISOR (sign. of driller or journeyman responsible for sitework if different from permittee)



# DORCHESTER COUNTY HEALTH DEPARTMENT ENVIRONMENTAL HEALTH DIVISION

---

3 Cedar St.  
Cambridge, MD 21613

410-228-1167  
FAX: 410-221-0996

Roger Harrell, MHA  
Health Officer

January 3, 2002

William Dale Jones  
5608 Daniels Choice Road  
Cambridge, MD. 21613

Re: Report of Water Chemistry Analysis for Arsenic  
Well Number: DO-940198  
Location: 5608 Daniels Choice Road  
Tax Map: 29, Parcel: 66; Sub: Daniels Choice, Lot:

Dear Well Owner,

On 9/26/2001 the water from your well was sampled for chemistry analysis. That sample was found to have 2 parts per billion (ppb) arsenic. This arsenic level is below the current maximum contaminant level (MCL) of 50 ppb, and it is **BELOW** the Environmental Protection Agency's proposed new MCL of 10 ppb. The EPA is setting the new lower MCL to further reduce the risk of cancer, heart disease and diabetes from long term exposure to low levels of arsenic in drinking water. Enclosed is a copy of our fact sheet on arsenic in drinking water. If you have any questions concerning this report, please call me at 410-228-1167.

Sincerely,

Kimberly Keene  
Environmental Health Aide III

cc: David Tull Well Drilling & Pump Co.